

Oceanis 41/45/48

Never has comfort been so great

In the 1980s, BENETEAU innovated and launched the Oceanis range; a range in which sailing focuses on sharing and the pleasure of living at sea. Safe and spirited, Oceanis yachts are as comfortable cruising as they are capable on longer offshore journeys.

Permanently being rethought to bring greater pleasure at sea, BENETEAU now launches 3 new models. The Oceanis 41, 45 and 48 offer more space and comfort and maintain the joy of safe sailing.



NEW



Oceanis 41/45/48

Never has comfort been
so great

An interior bathed in light, a real living space in which to feel good. The Oceanis has been reinvented and will make your dreams come true. Get carried away by this new world of comfort and enjoy an ocean of space...



BENETEAU

BROADENING THE HORIZONS OF YOUR DREAMS

www.beneteau.com

PRESS-RELEASE

beneteau-presse@beneteau.fr
www.beneteau.com



BENETEAU

Oceanis 41 / 45 / 48

Never has comfort been so great

THE OCEANIS SPIRIT REEXAMINED

+ On these 3 new models, BENETEAU has kept the essential features, the DNA of the Oceanis range:

- › A large cockpit enclosed by a rear seat
- › A mineral architecture, with elegant taut lines
- › Good performance under sail.

+ In addition, BENETEAU has made major improvements in the following areas:

- › The cockpit space and the volume of the fittings
- › Interior light
- › Good sea-keeping
- › Access to the sea

FEATURES RESERVED UP TILL NOW FOR SUPER YACHTS :

- › An aft bathing platform opening by remote control
- › Dock & Go technology on option
- › Multiple layout solutions in the saloon
- › On the Oceanis 48, original enhancement of the owner cabin

PRESS-RELEASE

beneteau-presse@beneteau.fr
[www. beneteau.com](http://www.beneteau.com)



BENETEAU

Oceanis 41/45/48

Never has comfort been so great

+ Comfort is primarily felt in terms of ergonomics:



> Thanks to the mainsail arch, it is easier to go inside, with a 45° companionway instead of the 60° on most standard yachts.



> The long roof glazing and the hull glazing take maximum advantage of the CE standard and enable natural lighting all along the hull.

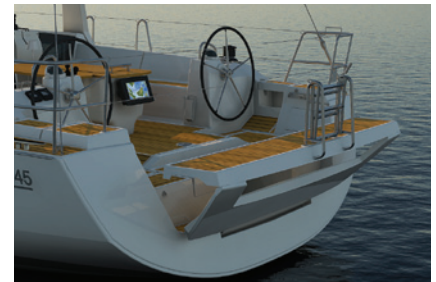

> To increase the size of the interior features without sacrificing the size of the cockpit, BENETEAU has reexamined the open transom feature. The Oceanis keeps the protective feature of the cockpit when sailing, with its large rear seat; and at the same time opens to the sea at anchor, like no other boat.



> The continuous bilge over the full length of the boat brings 2 major benefits in terms of comfort: A greater bed width in the forward cabins (75mm more on the 41 and an island bed on the 45), but also a larger deck (the very large cockpit can accommodate a good-sized table and fridge).

PRESS-RELEASE

beneteau-presse@beneteau.fr
www.beneteau.com



BENETEAU

Oceanis 41/45/48

Never has comfort been so great

+ Great developments have also been made in relation to sea-keeping:



> The bilge doesn't only offer more space inside, but it maximizes stability on the 1st heel angles, which enables high-performance sailing in a moderate heel.

> The mast was brought back to 47% from the bow (against 42% for most modern cruising yachts). Pascal Cong, the naval architect for the project, who together with Jean-Marie Finot, has been working with BENETEAU for many years, and their record of achievements for racing yachts is impressive (4 out of 5 of the last Vendée Globe races). They talk of this innovation: «A mast in the middle of the boat primarily achieves good mainsail/genoa balances, with little overlap, which gives the sails high aspect ratios but also makes the genoas easier to tack. Since we no longer need much overlap we can put the chain-plates on the deck line, which gets rid of the usual chain-plate stay bolts inside and simplifies the structure. We did not choose the self-tacking jib, because the loss in efficiency would be huge and the increase in pitching generated by the complete absence of overlap is extremely disadvantageous. This is why the genoas have a 108% overlap against 85% with self-tacking jibs; a very great difference.»

> The code 0 sail is available on option. It can be used to sail at a 4 knot windspeed, with a true wind between 65° and 120°.

> There is a mainsail arch enabling quick deployment of a Bimini top. It also increases safety in the cockpit without losing performance.

> These 3 new models are eligible for Dock&Go technology, a revolutionary and exclusive system. This new BENETEAU innovation makes manoeuvring in the harbour easier thanks to a «cross-shaped» joystick at the helm station. It has 90° rotation to port or starboard, forward and reverse on the spot rotation, enabling you to move the boat in a limited space and access the most difficult harbour berths.

PRESS-RELEASE

beneteau-presse@beneteau.fr
www.beneteau.com



BENETEAU

Oceanis 41/45/48

Never has comfort been so great

OCEANIS 41

Provisional technical characteristics

Length overall	12.43 m • 40.78 ft
Hull length	11.98 m • 39.30 ft
Waterline length	11.60 m • 38.06 ft
Hull width	4.20 m • 13.78 ft
Light displacement	8 340 kg • 18 386.55 lb
Min. deep draught	2.05 m • 6.73 ft
Weight of deep draught lest	2 300 kg • 5 070.63 lb
Max. air draught	19.50 m • 63.98 ft
Engine Power (HP)	40 CV • 40 HP
Fuel tank	200 L • 52.84 gal
Water tank	330 L • 87.19 gal(+ 200 L • + 52.84 gal on option)
CE Certification requested	A8 / B9 / C10
Naval architect	Finot-Conq & Associés
Interior designer	Nauta Design
Mainsail	41.7 m ² • 91.93 sq.ft
Genoa (104 %)	42.1 m ² • 92.81 sq.ft
Asymmetric spinnaker	130 m ² • 1399.30 sq.ft

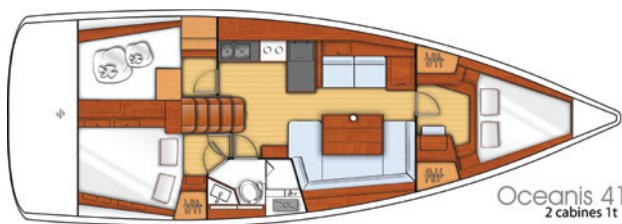

Oceanis 41
2 cabines 11

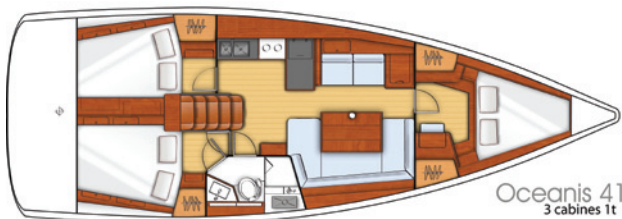

Oceanis 41
3 cabines 11

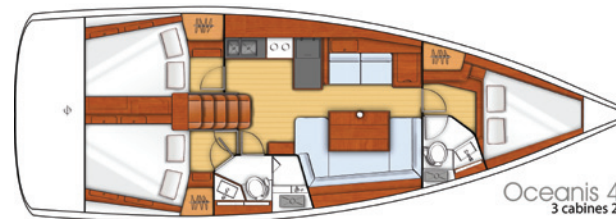

Oceanis 41
3 cabines 21

PRESS-RELEASE

beneteau-presse@beneteau.fr
www.beneteau.com



BENETEAU

Oceanis 41/45/48

Never has comfort been so great

OCEANIS 45

Provisional technical characteristics

Length overall	13.85 m • 45.44 ft
Hull length	13.50 m • 44.29 ft
Waterline length	13.05 m • 42.81 ft
Hull width	4.49 m • 14.73 ft
Light displacement	9 550 kg • 21 054.14 lb
Min. deep draught	2.15 m • 7.05 ft
Weight of deep draught lest	2 808 kg • 6 190.58 lb
Max. air draught	21 m • 68.90 ft
Engine Power (HP)	54 CV • 54 HP
Fuel tank	200 L • 52.84 gal
Water tank	330 L • 87.19 gal (+ 200 L • + 52.84 gal on option)
CE Certification requested	A10 / B11 / C12
Naval architect	Finot-Conq & Associés
Interior designer	Nauta Design
Mainsail	50 m ² • 110.23 sq.ft
Genoa (104 %)	50.5 m ² • 111.33 sq.ft
Asymmetric spinnaker	156 m ² • 1679.16 sq.ft



Oceanis 45
2 cabins

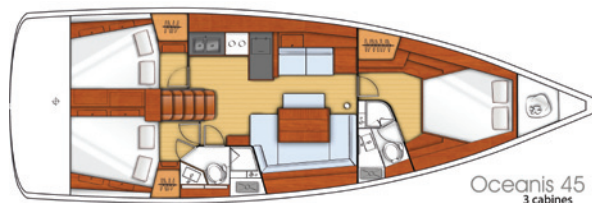

Oceanis 45
3 cabins



Oceanis 45
Family 3 cabins

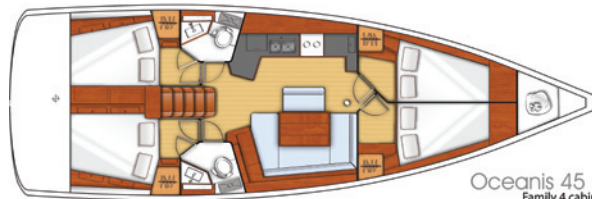

Oceanis 45
Family 4 cabins

PRESS-RELEASE

beneteau-presse@beneteau.fr
www.beneteau.com



BENETEAU

Oceanis 41/45/48

Never has comfort been so great

OCEANIS 48

Provisional technical characteristics

Length overall	14.60 m • 47.90 ft
Hull length	14.30 m • 46.92 ft
Waterline length	13.90 m • 45.60 ft
Hull width	4.74 m • 15.55 ft
Light displacement	13 300 kg • 29 321.47 lb
Min. deep draught	2.15 m • 7.05 ft
Weight of deep draught lest	3 550 kg • 7 826.41 lb
Max. air draught	19.53 m • 64.07 ft
Engine Power (HP)	75 CV • 75 HP
Fuel tank	200 L • 52.84 gal (+ 200 L • + 52.84 gal on option)
Water tank	330 L • 87.19 gal (+ 330 L • + 87.19 gal on option)
CE Certification requested	A12 / B14 / C14
Naval architect	Berret-RacoupeauYacht Design
Interior designer	Nauta Design
Mainsail	56.30 m ² • 124.12 sq.ft
Genoa (105 %)	56.30 m ² • 124.12 sq.ft
Asymmetric spinnaker	156 m ² • 1679.16 sq.ft

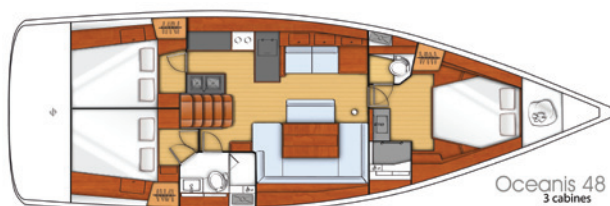
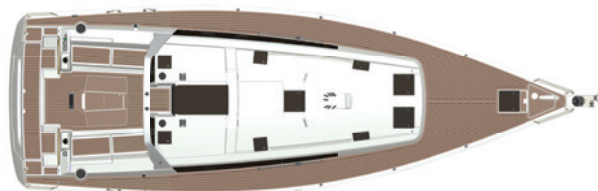

PRESS-RELEASE

beneteau-presse@beneteau.fr
www. beneteau.fr

